

## side-tab pull plugs **ST SERIES**

This tapered plug features a side-tab design that extends above the flange making it easy to grasp and remove from a variety of threaded and non-threaded fittings. Great for use in hard-to-reach locations. Side tab will facilitate ease of removal.

**When used as a PLUG:** "B" dimension should be at least .020" more than diameter to be plugged. Larger diameters may require more interference.

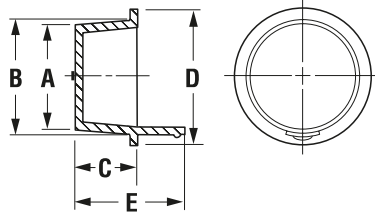

### Specifications

- Material: Low-Density Polyethylene
- Colour: Orange

Part Number	To Plug Thread Sizes			Dimensions										Standard Package	
	NPT/BSP	Standard	Metric	A		B		C		D		E		Pieces	Lbs.
				in	mm	in	mm	in	mm	in	mm	in	mm		
ST 236-X	-	-	-	.239	6.07	.303	7.70	.41	10.41	.47	11.94	.66	16.76	45000	23
ST 236-L	-	-	-	.267	6.78	.335	8.51	.41	10.41	.47	11.94	.66	16.76	20000	11
ST 237-Y	-	3/8	M10/M10x1.25	.299	7.59	.367	9.32	.38	9.65	.50	12.70	.66	16.76	30000	21
ST 229-Z	1/8	-	-	.331	8.41	.397	10.08	.38	9.65	.56	14.22	.63	16.00	10000	8
ST 238-D	-	7/16	M12	.362	9.19	.428	10.87	.41	10.41	.56	14.22	.66	16.76	20000	15
ST 181	1/4	1/2	M14	.422	10.72	.486	12.34	.41	10.41	.63	16.00	.78	19.81	15000	15
ST 240	-	-	M14x1.5	.448	11.38	.512	13.00	.41	10.41	.66	16.76	.78	19.81	15000	17
ST 189	-	9/16	-	.472	11.99	.548	13.92	.47	11.94	.69	17.53	.84	21.34	10000	13
ST 189-2	1	-	M16	.500	12.70	.568	14.43	.47	11.94	.72	18.29	.85	21.59	10000	12
ST 241	-	-	-	.533	13.54	.608	15.44	.44	11.18	.75	19.05	.85	21.59	5000	7
ST 188	3/8	-	M-18	.551	14.00	.633	16.08	.50	12.70	.78	19.81	.88	22.35	10000	17
ST 242	-	-	M18x1.5	.580	14.73	.668	16.97	.53	13.46	.81	20.57	.91	23.11	7500	13
ST 242-2	-	-	-	.610	15.49	.695	17.65	.53	13.46	.84	21.34	.91	23.11	7500	13
ST 243	-	3/4	M20	.642	16.31	.729	18.52	.50	12.70	.88	22.35	.88	22.35	7500	14
ST 191	-	-	M20x1.5	.678	17.22	.755	19.18	.53	13.46	.88	22.35	.91	23.11	7500	16
ST 203	1/2	-	M22	.691	17.55	.787	19.99	.59	14.99	.94	23.88	.97	24.64	5000	12
ST 245	-	-	M22-1.5	.727	18.47	.825	20.96	.59	14.99	1.00	25.40	.97	24.64	5000	13
ST 246	-	7/8	M24	.752	19.10	.849	21.56	.59	14.99	1.00	25.40	.97	24.64	5000	14
ST 204	-	-	M24x2	.803	20.40	.912	23.16	.65	16.51	1.06	26.92	1.03	26.16	3500	11
ST 247	-	-	-	.819	20.80	.933	23.70	.62	15.75	1.12	28.45	1.00	25.40	3000	10
ST 192-2	3/4	-	M27	.869	22.07	.973	24.71	.66	16.76	1.13	28.70	1.03	26.16	2500	9
ST 248	-	1-1/16	M27-12	.915	23.24	1.040	26.42	.72	18.29	1.16	29.46	1.09	27.69	2500	10
ST 249	-	-	M30x2	.967	24.56	1.092	27.74	.78	19.81	1.25	31.75	1.16	29.46	2500	12
ST 153	-	-	M30x2	.997	25.32	1.144	29.06	.78	19.81	1.31	33.27	1.16	29.46	4000	20
ST 193	-	-	M33	1.093	27.76	1.219	30.96	.78	19.81	1.41	35.81	1.16	29.46	1500	9
ST 250	-	1-5/16	M33x2M36	1.179	29.95	1.286	32.66	.75	19.05	1.44	36.58	1.13	28.70	1500	9
ST 205	-	-	-	1.233	31.32	1.358	34.49	.84	21.34	1.50	38.10	1.22	30.99	1500	10
ST 254	1-1/4	-	-	1.451	36.86	1.601	40.67	.75	19.05	1.75	44.45	1.13	28.70	1000	8
ST 255	-	-	-	1.633	41.48	1.750	44.45	.75	19.05	1.84	46.74	1.13	28.70	1000	9