

wide-flange **WF SERIES**

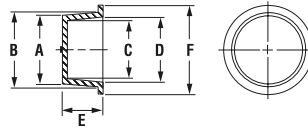

When used as a PLUG: "B" dimension should be at least .020" larger than diameter to be plugged. Larger diameters may require more interference.

When used as a CAP: "C" dimension should be at least .020" less than diameter to be capped. Larger diameters may require more interference.



Engineered with a wider and thicker flange design for added protection and security. This versatile part can be used as a cap or a plug.

Specifications

- Material: Low-Density Polyethylene
- Colour: Yellow
- Applicable Spec: **NAS-816**

| Part Number | TO PLUG | | | TO CAP | | | Dimensions | | | | | | | | Standard Package | | | | | |
|-------------|--------------|----------|------------------|--------------|----------|------------|------------|-------|-------|-------|--------|-------|-------|-------|------------------|-------|------|--------|--------|------|
| | Thread Sizes | | | Thread Sizes | | | TO PLUG | | | | TO CAP | | | | in | mm | in | mm | Pieces | Lbs. |
| | NPT/BSP | Standard | Metric | NPT/BSP | Standard | Metric | A | B | C | D | E | F | | | | | | | | |
| WF 1 | - | - | - | - | - | - | .116 | 2.95 | .182 | 4.62 | .053 | 1.35 | .133 | 3.38 | .47 | 11.94 | .50 | 12.70 | 15000 | 11 |
| WF 2 | - | - | M-6 | - | - | M-4 | .174 | 4.42 | .240 | 6.10 | .112 | 2.84 | .188 | 4.78 | .47 | 11.94 | .56 | 14.22 | 12000 | 11 |
| WF 3 | - | - | - | - | - | - | .236 | 5.99 | .296 | 7.52 | .174 | 4.42 | .245 | 6.22 | .40 | 10.16 | .63 | 16.00 | 10000 | 11 |
| WF 4 | - | 3/8 | - | - | 15/64 | - | .300 | 7.62 | .365 | 9.27 | .235 | 5.97 | .312 | 7.92 | .40 | 10.16 | .69 | 17.53 | 8000 | 11 |
| WF 5 | 1/8 | - | M-10 | - | - | M-8 | .334 | 8.48 | .392 | 9.96 | .270 | 6.86 | .338 | 8.59 | .40 | 10.16 | .72 | 18.29 | 7000 | 10 |
| WF 6 | - | 7/16 | - | - | - | - | .368 | 9.35 | .418 | 10.62 | .298 | 7.57 | .356 | 9.04 | .40 | 10.16 | .75 | 19.05 | 7000 | 12 |
| WF 7 | - | - | M-12 | 1/8 | 3/8 | M-10 | .397 | 10.08 | .447 | 11.35 | .329 | 8.36 | .387 | 9.83 | .40 | 10.16 | .78 | 19.81 | 6000 | 10 |
| WF 8 | 1/4 | 1/2 | - | 1/8 | - | - | .427 | 10.85 | .475 | 12.07 | .357 | 9.07 | .415 | 10.54 | .40 | 10.16 | .81 | 20.57 | 10000 | 19 |
| WF 9 | - | - | - | - | - | - | .435 | 11.05 | .509 | 12.93 | .365 | 9.27 | .450 | 11.43 | .47 | 11.94 | .83 | 21.08 | 10000 | 20 |
| WF 9-2 | - | - | M-14 | - | 7/16 | - | .460 | 11.68 | .500 | 12.70 | .396 | 10.06 | .444 | 11.28 | .38 | 9.65 | .75 | 19.05 | 6000 | 10 |
| WF 10 | - | 9/16 | - | - | 1/2 | M-12 | .481 | 12.22 | .547 | 13.89 | .409 | 10.39 | .484 | 12.29 | .47 | 11.94 | .88 | 22.35 | 10000 | 22 |
| WF 11 | - | 5/8 | M-16 | 1/4 | - | - | .530 | 13.46 | .616 | 15.65 | .466 | 11.84 | .567 | 14.40 | .47 | 11.94 | .94 | 23.88 | 6500 | 16 |
| WF 11-2 | 3/8 | - | - | - | 9/16 | M-14 | .560 | 14.22 | .631 | 16.03 | .497 | 12.62 | .579 | 14.71 | .47 | 11.94 | .97 | 24.64 | 6500 | 17 |
| WF 12 | - | - | M-18 | - | 5/8 | M-16 | .590 | 14.99 | .667 | 16.94 | .519 | 13.18 | .605 | 15.37 | .53 | 13.46 | 1.00 | 25.40 | 5000 | 15 |
| WF 13 | - | - | - | - | - | - | .610 | 15.49 | .687 | 17.45 | .548 | 13.92 | .634 | 16.10 | .53 | 13.46 | 1.03 | 26.16 | 5000 | 15 |
| WF 14 | - | 3/4 | M-18, M-20 | - | - | - | .628 | 15.95 | .725 | 18.42 | .558 | 14.17 | .667 | 16.94 | .53 | 13.46 | 1.06 | 26.92 | 5000 | 16 |
| WF 15 | - | - | M-20 | 3/8 | - | - | .658 | 16.71 | .750 | 19.05 | .588 | 14.94 | .691 | 17.55 | .53 | 13.46 | 1.09 | 27.69 | 5000 | 18 |
| WF 16 | 1/2 | - | - | - | - | M-18 | .690 | 17.53 | .776 | 19.71 | .620 | 15.75 | .718 | 18.24 | .56 | 14.22 | 1.13 | 28.70 | 4000 | 14 |
| WF 17 | - | - | M-22 | - | 3/4 | - | .725 | 18.42 | .812 | 20.62 | .663 | 16.84 | .759 | 19.28 | .60 | 15.24 | 1.16 | 29.46 | 3500 | 13 |
| WF 18 | - | - | - | - | - | - | .755 | 19.18 | .870 | 22.10 | .693 | 17.60 | .820 | 20.83 | .59 | 14.99 | 1.19 | 30.23 | 5000 | 20 |
| WF 19 | - | - | - | - | 7/8 | - | .820 | 20.83 | .930 | 23.62 | .755 | 19.18 | .876 | 22.25 | .62 | 15.75 | 1.25 | 31.75 | 2500 | 11 |
| WF 20 | - | - | - | - | - | - | .825 | 20.96 | .929 | 23.60 | .763 | 19.38 | .877 | 22.28 | .65 | 16.51 | 1.25 | 31.75 | 2500 | 11 |
| WF 21 | 3/4 | - | - | - | - | M-22 | .866 | 22.00 | .976 | 24.79 | .804 | 20.42 | .925 | 23.50 | .65 | 16.51 | 1.81 | 45.97 | 2500 | 12 |
| WF 22 | 3/4 | 1-1/16 | M-26, M-27 | 5/8 | - | M-24 | .915 | 23.24 | 1.035 | 26.29 | .840 | 21.34 | .972 | 24.69 | .72 | 18.29 | 1.34 | 34.04 | 2500 | 15 |
| WF 23 | - | - | - | - | - | - | .984 | 24.99 | 1.106 | 28.09 | .920 | 23.37 | 1.040 | 26.42 | .75 | 19.05 | 1.44 | 36.58 | 1500 | 9 |
| WF 24-2 | 7/8 | - | M-25 | - | - | M-27, 28 | 1.150 | 29.21 | 1.284 | 32.61 | 1.080 | 27.43 | 1.220 | 30.99 | .75 | 19.05 | 1.56 | 39.62 | 1500 | 11 |
| WF 25 | 1 | 1-5/16 | M-32, M-33 | 7/8 | - | M-30 | 1.180 | 29.97 | 1.314 | 33.38 | 1.115 | 28.32 | 1.260 | 32.00 | .75 | 19.05 | 1.56 | 39.62 | 1500 | 11 |
| WF 26 | - | - | M-35, M-36 | - | - | M-32, M-33 | 1.236 | 31.39 | 1.382 | 35.10 | 1.166 | 29.62 | 1.324 | 33.63 | .75 | 19.05 | 1.69 | 42.93 | 1500 | 12 |
| WF 27 | - | - | - | - | - | - | 1.312 | 33.32 | 1.465 | 37.21 | 1.248 | 31.70 | 1.417 | 35.99 | .93 | 23.62 | 1.84 | 46.74 | 1000 | 11 |
| WF 27-2 | - | - | - | - | - | - | 1.312 | 33.32 | 1.466 | 37.24 | 1.249 | 31.72 | 1.427 | 36.25 | .78 | 19.81 | 1.84 | 46.74 | 1000 | 10 |
| WF 28-2 | - | - | - | - | - | - | 1.420 | 36.07 | 1.510 | 38.35 | 1.351 | 34.32 | 1.452 | 36.88 | .81 | 20.57 | 1.75 | 44.45 | 1000 | 10 |
| WF 28 | - | - | - | - | - | - | 1.452 | 36.88 | 1.604 | 40.74 | 1.378 | 35.00 | 1.552 | 39.42 | .75 | 19.05 | 1.94 | 49.28 | 1000 | 12 |
| WF 29 | 1-1/4 | - | M-39, M-40, M-42 | - | 1-1/8 | M-38 | 1.580 | 40.13 | 1.714 | 43.54 | 1.516 | 38.51 | 1.649 | 41.88 | .75 | 19.05 | 2.06 | 52.32 | 1000 | 12 |
| WF 30 | 1-1/2 | 1-7/8 | M-48 | - | - | M-45 | 1.730 | 43.94 | 1.888 | 47.96 | 1.650 | 41.91 | 1.828 | 46.43 | .75 | 19.05 | 2.31 | 58.67 | 500 | 9 |
| WF 31 | - | - | M-48 | 1-1/2 | 1-7/8 | - | 1.810 | 45.97 | 1.975 | 50.17 | 1.731 | 43.97 | 1.916 | 48.67 | .75 | 19.05 | 2.38 | 60.45 | 500 | 10 |
| 1064 | - | - | - | - | - | - | 1.900 | 48.26 | 1.990 | 50.55 | 1.780 | 45.21 | 1.870 | 47.50 | .57 | 14.48 | 2.34 | 59.44 | 2500 | 40 |
| WF 32 | - | - | - | 1-1/2 | - | - | 1.850 | 46.99 | 2.020 | 51.31 | 1.788 | 45.42 | 1.973 | 50.11 | 1.12 | 28.45 | 2.44 | 61.98 | 500 | 10 |
| WF 33 | - | - | - | - | - | - | 1.927 | 48.95 | 2.058 | 52.27 | 1.857 | 47.17 | 2.005 | 50.93 | .75 | 19.05 | 2.38 | 60.45 | 500 | 8 |
| WF 34 | - | 2-1/4 | M-55, M-56 | 1-3/4 | - | M-52 | 2.067 | 52.50 | 2.243 | 56.97 | 2.005 | 50.93 | 2.197 | 55.80 | 1.12 | 28.45 | 2.69 | 68.33 | 250 | 6 |
| WF 34-2 | - | - | - | - | - | - | 2.072 | 52.63 | 2.263 | 57.48 | 2.010 | 51.05 | 2.218 | 56.34 | 1.12 | 28.45 | 2.69 | 68.33 | 250 | 6 |
| WF 35 | 2 | - | M-58, M-60 | - | 2-1/4 | M-58 | 2.136 | 54.25 | 2.312 | 58.72 | 2.074 | 52.68 | 2.265 | 57.53 | 1.12 | 28.45 | 2.75 | 69.85 | 250 | 6 |
| WF 36 | - | - | M-60, M-62 | 2 | - | M-60 | 2.298 | 58.37 | 2.464 | 62.59 | 2.235 | 56.77 | 2.416 | 61.37 | 1.12 | 28.45 | 2.88 | 73.15 | 250 | 6 |
| WF 37 | - | - | - | - | 2-1/2 | - | 2.395 | 60.83 | 2.602 | 66.09 | 2.333 | 59.26 | 2.556 | 64.92 | 1.25 | 31.75 | 3.00 | 76.20 | 250 | 8 |
| WF 38 | - | - | - | - | - | - | 2.305 | 58.55 | 2.620 | 66.55 | 2.245 | 57.02 | 2.583 | 65.61 | 1.00 | 25.40 | 3.06 | 77.72 | 300 | 9 |
| WF 39 | - | - | - | - | - | - | 2.475 | 62.87 | 2.725 | 69.22 | 2.405 | 61.09 | 2.677 | 68.00 | 1.37 | 34.80 | 3.16 | 80.26 | 250 | 7 |
| WF 40 | 2-1/2 | - | - | - | - | - | 2.638 | 67.01 | 2.759 | 70.08 | 2.568 | 65.23 | 2.704 | 68.68 | .81 | 20.57 | 3.21 | 81.53 | 250 | 7 |
| WF 41 | - | - | M-75, M-76 | 2-1/2 | - | - | 2.685 | 68.20 | 2.955 | 75.06 | 2.623 | 66.62 | 2.917 | 74.09 | 1.12 | 28.45 | 3.44 | 87.38 | 250 | 8 |
| WF 42 | - | - | - | - | - | - | 2.994 | 76.05 | 3.150 | 80.01 | 2.924 | 74.27 | 3.097 | 78.66 | .87 | 22.10 | 3.59 | 91.19 | 250 | 8 |
| WF 43 | - | - | - | - | - | - | 2.990 | 75.95 | 3.250 | 82.55 | 2.920 | 74.17 | 3.202 | 81.33 | 1.12 | 28.45 | 3.75 | 95.25 | 250 | 10 |
| WF 44 | - | - | - | 3 | - | - | 3.225 | 81.92 | 3.562 | 90.47 | 3.154 | 80.11 | 3.515 | 89.28 | 1.25 | 31.75 | 4.00 | 101.60 | 150 | 7 |
| WF 45 | - | - | - | - | - | - | 3.324 | 84.43 | 3.458 | 87.83 | 3.244 | 82.40 | 3.398 | 86.31 | .87 | 22.10 | 3.88 | 98.55 | 200 | 9 |
| WF 46 | 3-1/2 | - | - | 3-1/2 | - | - | 3.790 | 96.27 | 3.920 | 99.57 | 3.710 | 94.23 | 3.840 | 97.54 | .87 | 22.10 | 4.34 | 110.24 | 250 | 12 |