

SILICONE WASHER PULL PLUGS

Series WPP

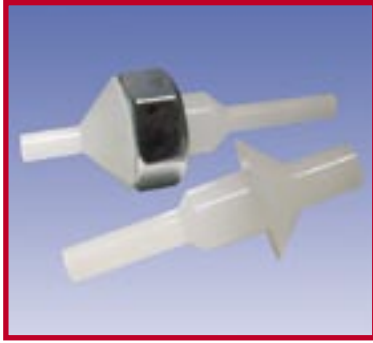

- pull through hole masking with surrounding washer area coverage.
- pull through washer plugs feature a second pull tab for easy removal.
- the plug diameter (A) should be at least 5% larger than the hole diameter being plugged.
- sizes to fit metric and standard threads
- contact our Sales Department for sizes and pricing.
- temperature resistant up to 315°C / 600°F and durable for repeat use.

PART NUMBER	FITS THREADS	A	B	C	D	E	F	G	QTY PER BAG
		in	in	in	in	in	in	in	
WPP-114	M3	.394	.114	.098	.098	.394	.591	.787	1000
WPP-150	M4	.394	.150	.118	.118	.394	.591	.787	1000
WPP-177	10-24, M5	.472	.177	.118	.118	.394	.591	.787	1000
WPP-195	12-24	.561	.195	.160	.110	.500	.390	.390	1000
WPP-197		.591	.197	.157	.157	.394	.591	.787	1000
WPP-217	M6	.551	.217	.157	.157	.394	.591	.787	500
WPP-225	1/4-20	.625	.225	.190	.128	.500	.390	.390	500
WPP-285	5/16-18, M8	.591	.285	.240	.160	.500	.390	.390	500
WPP-285-L	5/16-18, M8	.650	.285	.240	.116	.500	.383	1.00	500
WPP-291	5/16-18, M8	.630	.291	.157	.157	.394	.591	.787	500
WPP-315		.591	.315	.197	.197	.394	.394	.602	500
WPP-330		.700	.330	.165	.165	.390	.530	.651	500
WPP-345	3/8-16	.811	.345	.290	.195	.500	.390	.390	250
WPP-362	M10	.701	.362	.197	.197	.394	.591	.984	250
WPP-375	M10	.787	.375	.320	.214	.500	.390	.390	250
WPP-430	M12	.787	.430	.360	.245	.500	.390	.390	250
WPP-430-L	M12	1.120	.430	.200	.200	.500	1.300	1.300	250
WPP-433	1/2-13	.787	.433	.197	.197	.394	.591	.984	250
WPP-445		.811	.445	.360	.245	.395	.500	.500	250
WPP-460		1.062	.460	.390	.265	.300	.390	.390	250

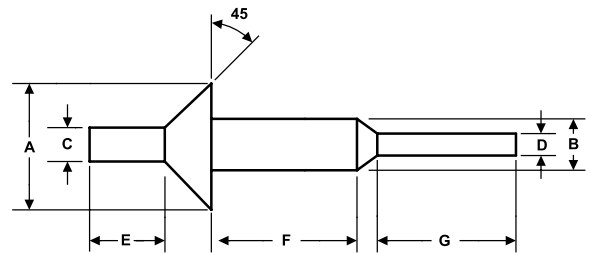

WPP SERIES WASHER PULL PLUGS